

Summary Description of Theatre and Resources

Physical Layout of the Theatre

Curtain Players is a 78 seat performance space with the seating arranged in 6 rows of 13 seats each. The first row of seating is 18 inches from the stage.

The stage is approximately 15 feet by 32 feet as indicated in the diagram below. The ceiling height over the stage is 10 feet 4 inches. There is no fly. No trap doors exist in the stage floor. We do have a grid system on the ceiling above the stage for hanging curtains, small lights, etc.

There are 3 possible exits from the stage/backstage area. There is one door on the stage right wall approximately 6 feet from the back wall, which leads to the hallway to the Green Rooms. There is a 3 foot wide stairway located downstage right which leads to the Audience Left aisle, which is 6 feet wide. There is a 20 inch escape stair located down stage left which leads to the Audience Right aisle, which is 33 inches wide.

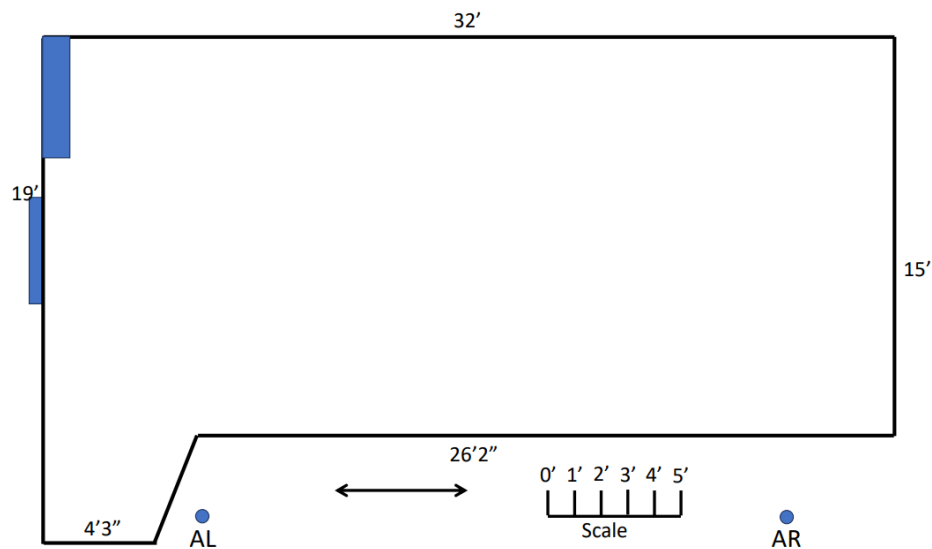

Scenery (flats and platforms) in stock

- Our Broadway-style flats are 10 feet tall and we probably have an adequate supply for your production.
- We have a number of doors already in frames in flats. These are in a variety of styles, including a screen door and glass-framed French doors.
- We are unable to fly anything.
- Because of our relatively low ceiling, you are rather limited in what can be done with risers or other changes to floor height, but we do have several 6 inch platforms in assorted sizes.

Lighting capabilities

- Fresnels, parcans, ETC parnells, ellipsoidals, and small can lights are available. No LED instruments currently.
- 30 channels, 5 dimmers (6 channels each).
- Lights can be repositioned, and there are multiple outlets for practical or over stage lights. Placement of the larger-sized lighting instruments is limited over the stage by our relatively low ceiling and ordinarily cannot be placed directly over the stage.
- ETC Element lightboard.
- Selection of gels and gobos in stock.

Sound capabilities

- Capable of running 8 speakers at once, including the 2 main house speakers; they can be used on stage or backstage, including in the Green Rooms.
- SFX by Timeline Theatrics, running on a Windows 7 desktop.